

SCS19 High Precision Pressure Sensor



Product Introduction

SCS19 series pressure sensor adopts medium isolation type package. This series of sensors is designed based on harsh application environment. The pressure-sensitive chip is encapsulated in a cavity filled with silicone oil, and the cavity is composed of a corrugated diaphragm and a stainless steel shell seal. This series of sensors covers the pressure measurement range of 0~70MPa, and can provide three types of pressure measurement: absolute pressure (A), gauge pressure (G) and sealed gauge pressure (S). SCS19 series sensors have the advantages of high repeatability, high reliability and wide operating temperature range.

Features



Dielectric Isolation
Package



Operating Temperature
Range: -55~180℃



High Reliability



**Absolute Pressure, Gauge
Pressure and Sealing Gauge
Pressure are Optional**

Application



**Process Control
System**



**Hydraulic System
and Valves**



Oil Drilling

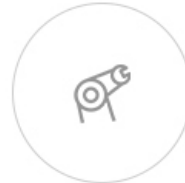

Industrial Automation

Technical Indicators

Standard Range			
Range Code	Pressure Range	Type	Notes
15K0	0~15kPa	G/A	2psi
35K0	0~35kPa	G/A	5psi
100K	0~100kPa	G/A	15psi
200K	0~200kPa	G/A	30psi
350K	0~350kPa	G/A	50psi
700K	0~700kPa	G/A	100psi
01M0	0~1MPa	G/A	150psi
02M0	0~2MPa	G/A	300psi
03M5	0~3.5MPa	G/S/A	500psi
07M0	0~7MPa	S/A	1000psi
10M0	0~10MPa	S/A	1500psi
20M0	0~20MPa	S/A	3000psi
35M0	0~35MPa	S/A	5000psi
70M0	0~70MPa	S/A	10000psi
Max Overload Pressure	2X		Rated Pressure

Electrical Performance		
Parameter	Numerical Value	Unit
Excitation	2~10	V
	0.2~2	mA
Bridge Resistance	3~7.5	kΩ

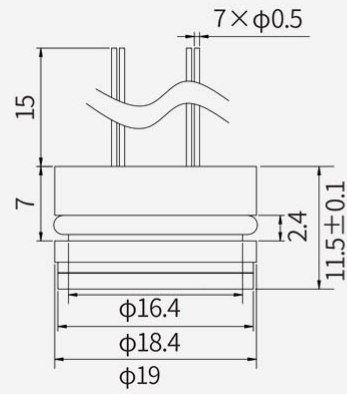
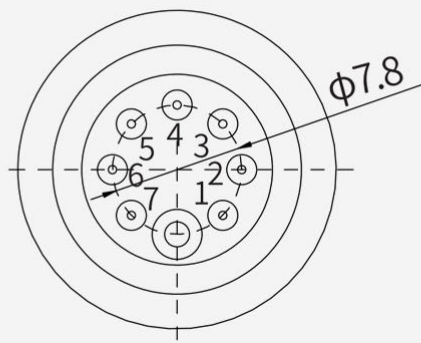

Absolute pressure/sealed gauge pressure below 10MPa

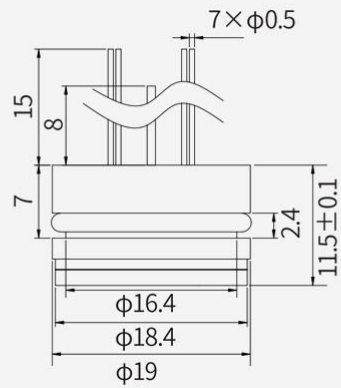
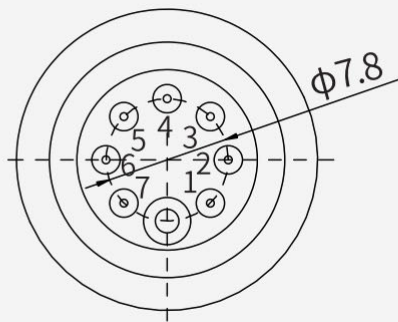

Gauge pressure below 10MPa